

Former Bakery - Retail Space

1616-J Battleground Avenue | Greensboro, NC 27408



- ♦ Available For Lease (Oct. 2025)
- ♦ 1,362 RSF (24' x 50' ±)
- ♦ Excellent Visibility & Access
- ♦ High Traffic Area (28,825 AADT)
- ♦ Great Demographics
- ♦ Plenty of Parking
- ♦ Call For More Details

Conveniently located on Battleground Avenue and minutes from The Friendly Center, Green Valley Road, and Downtown Greensboro.

The space is currently used as a Bakery and includes a Kitchen Hood (5' x 5'), a 100 gallon above ground grease trap, a two compartment sink, and one hand sink.



JJ Joubran, CCIM, SIOR
(336) 270-9775
JJ@JoubranCommercial.com

1616-J Battleground

1,362 RSF +/-

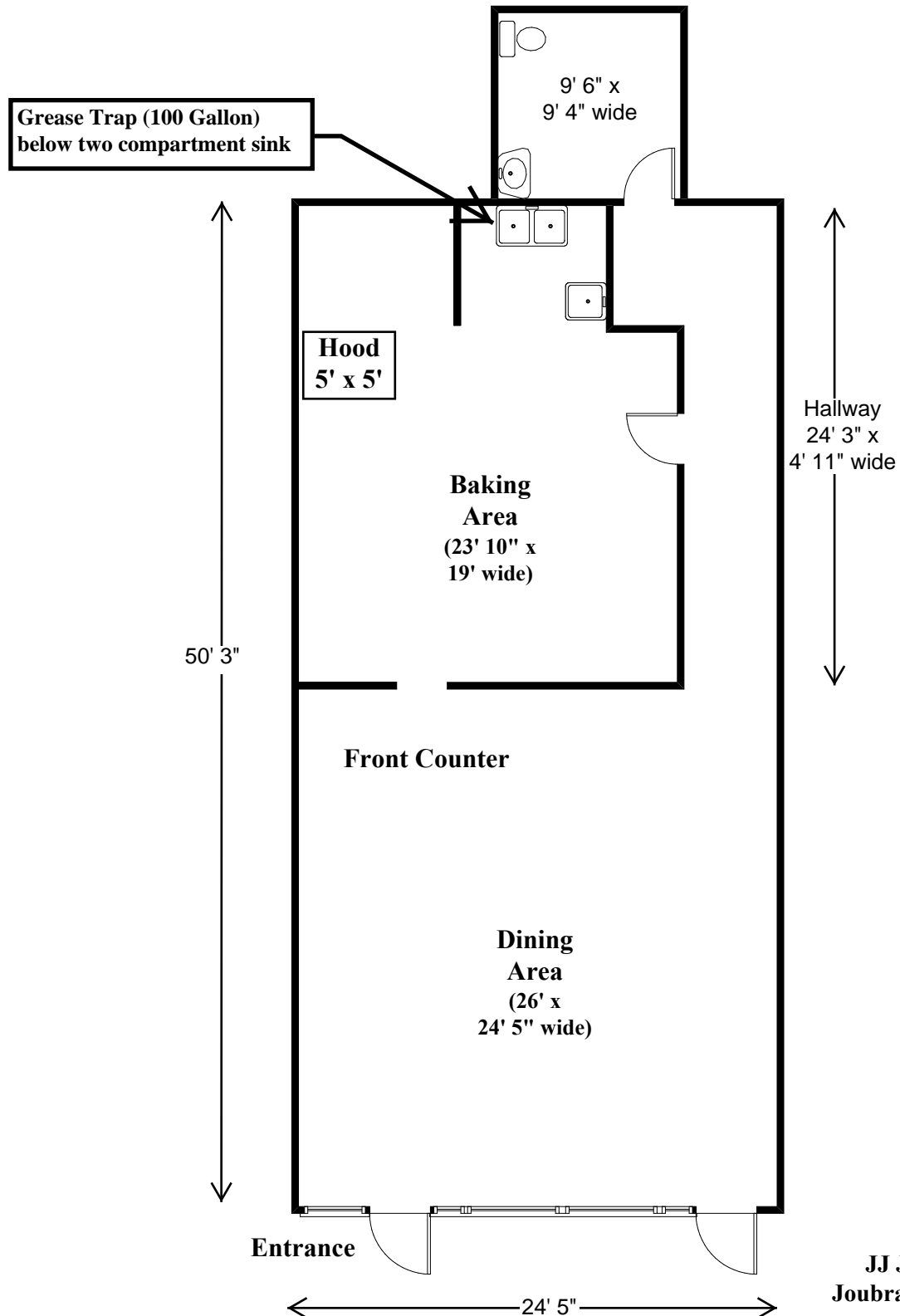

Contact:
JJ Joubran, CCIM, SIOR
Joubran Commercial Properties
(336) 270-9775
JJ@JoubranCommercial.com
www.JoubranCommercial.com

Former Bakery - Retail Space

1616-J Battleground Avenue | Greensboro, NC 27408

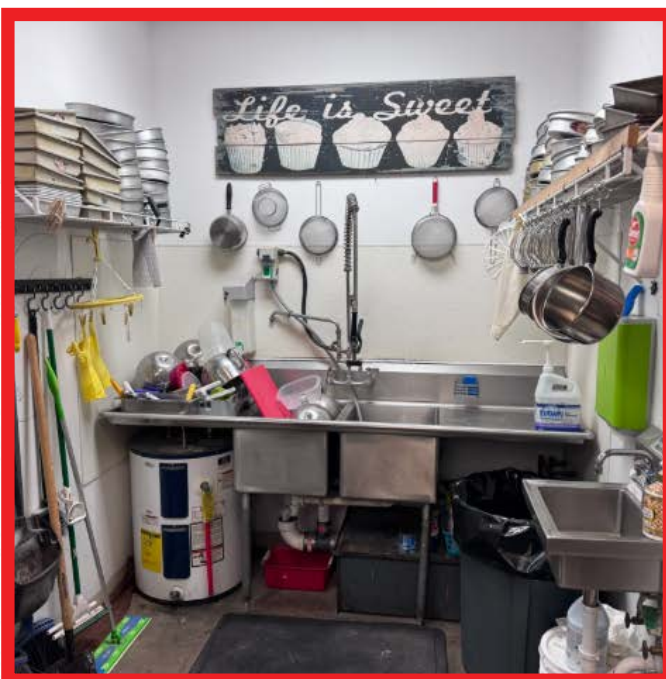

JJ Joubran, CCIM, SIOR

(336) 270-9775

JJ@JoubranCommercial.com

Dover Square Retail Center
1616-J Battleground Avenue, Greensbor, NC

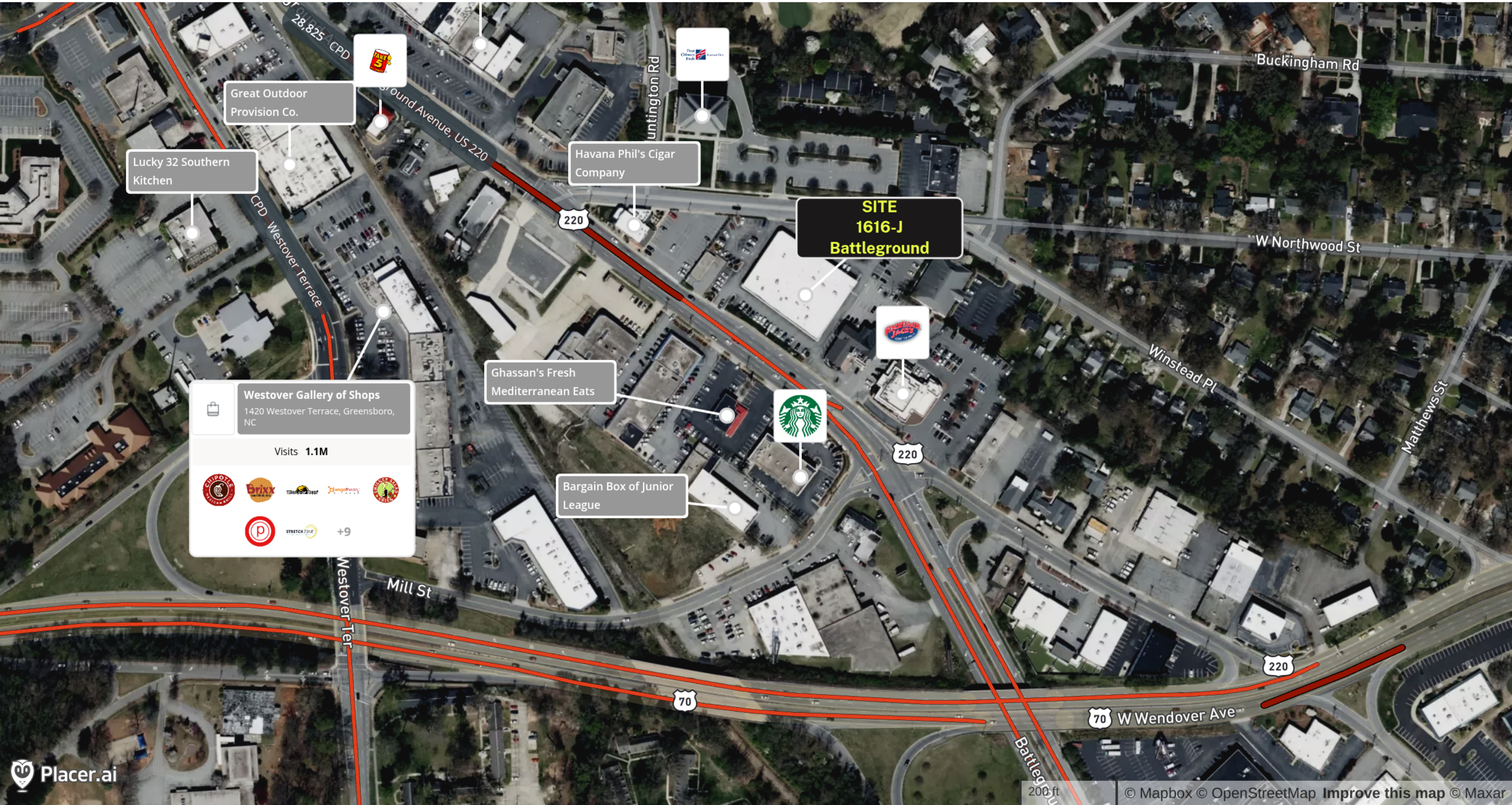

© Mapbox © OpenStreetMap Improve this map © Maxar