

# Retail Building in Midtown on Battleground

1212 Battleground Avenue | Greensboro, NC 27408



- ◆ Available For Sale or Lease
- ◆ 4,800 SF on 0.68 AC +/-
- ◆ Plenty of Parking - 25 spaces
- ◆ Mezzanine Storage Space
- ◆ Zoned Light Industrial
- ◆ Call For More Details

Conveniently located in Midtown on Battleground Avenue with access off Battleground and Grecale.

The property is 4,800 sf with 800 sf of office space and 4,000 sf of automotive shop space.

The property provide excellent access with great visibility and signage and is minutes from Downtown.

**JJ Joubran, CCIM**  
(336) 270-9775  
JJ@JoubranCommercial.com



# 1212 Battleground Avenue

## 4,800 SF

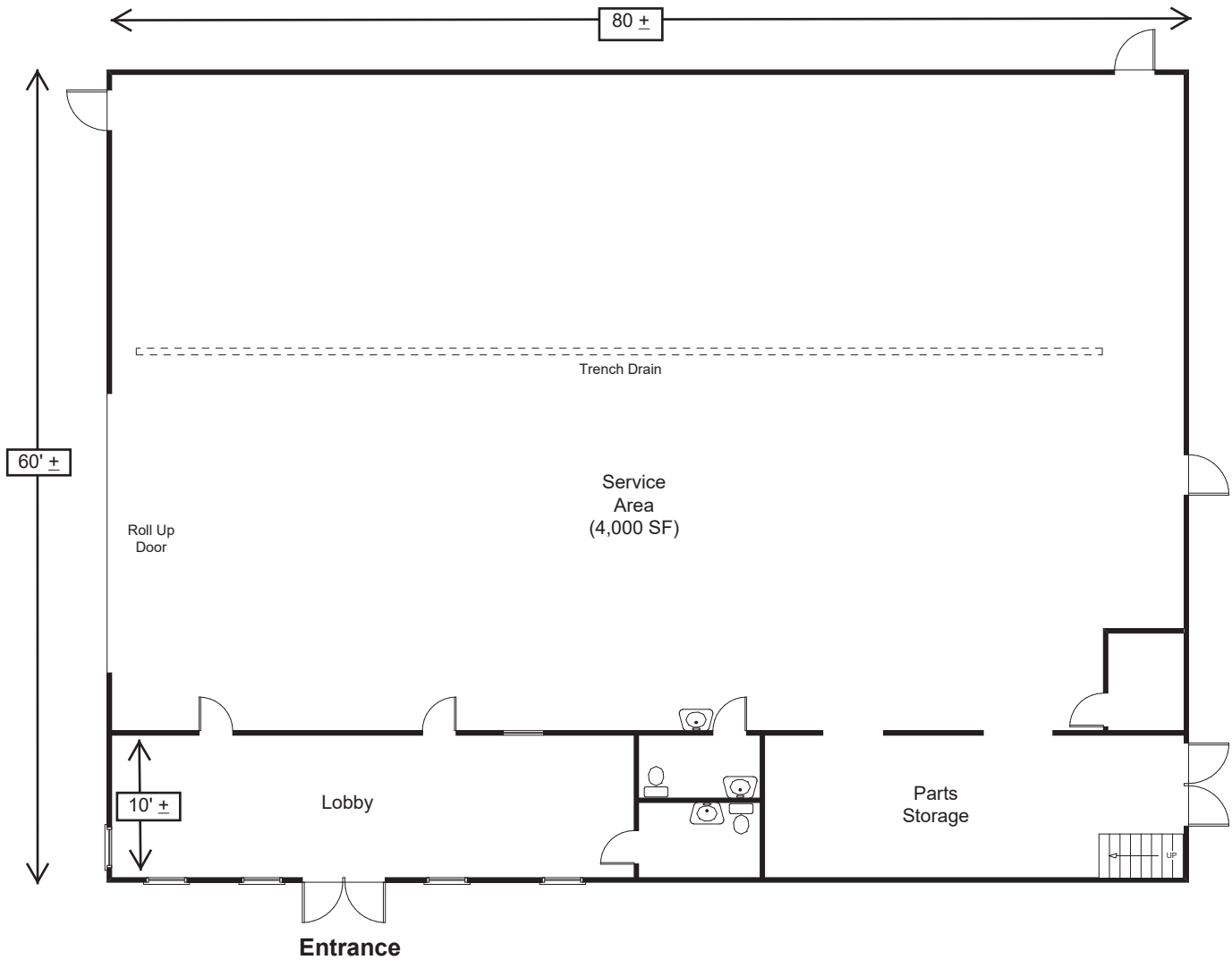

*Contact:*  
**JJ Joubran, CCIM**  
**Joubran Commercial Properties**  
**(336) 270-9775**  
[JJ@JoubranCommercial.com](mailto:JJ@JoubranCommercial.com)  
[www.JoubranCommercial.com](http://www.JoubranCommercial.com)

# 1212 Battleground Avenue Site Plan

Grecade Street

Entrance

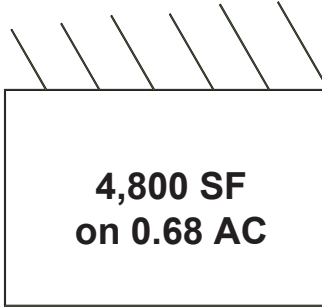

25 parking space  
(potential for more)

Entrance

Battleground Avenue



*Contact:*

**JJ Joubran, CCIM**  
Joubran Commercial Properties  
(336) 270-9775

[JJ@JoubranCommercial.com](mailto:JJ@JoubranCommercial.com)  
[www.JoubranCommercial.com](http://www.JoubranCommercial.com)