

Retail Building in Midtown on Battleground

1212 Battleground Avenue | Greensboro, NC 27408



- ◆ Available For Lease
- ◆ 4,800 SF on 0.68 AC +/-
- ◆ Plenty of Parking - 25 spaces
- ◆ Mezzanine Storage Space
- ◆ Zoned Light Industrial
- ◆ Formerly R & R Automotive

Conveniently located in Midtown on Battleground Avenue with access off Battleground and Greccade.

The property is 4,800 sf with 800 sf of office space and 4,000 sf of automotive shop space.

The property provide excellent access with great visibility and signage and is minutes from Downtown.

JJ Joubran, CCIM
(336) 270-9775
JJ@JoubranCommercial.com



1212 Battleground Avenue

4,800 SF

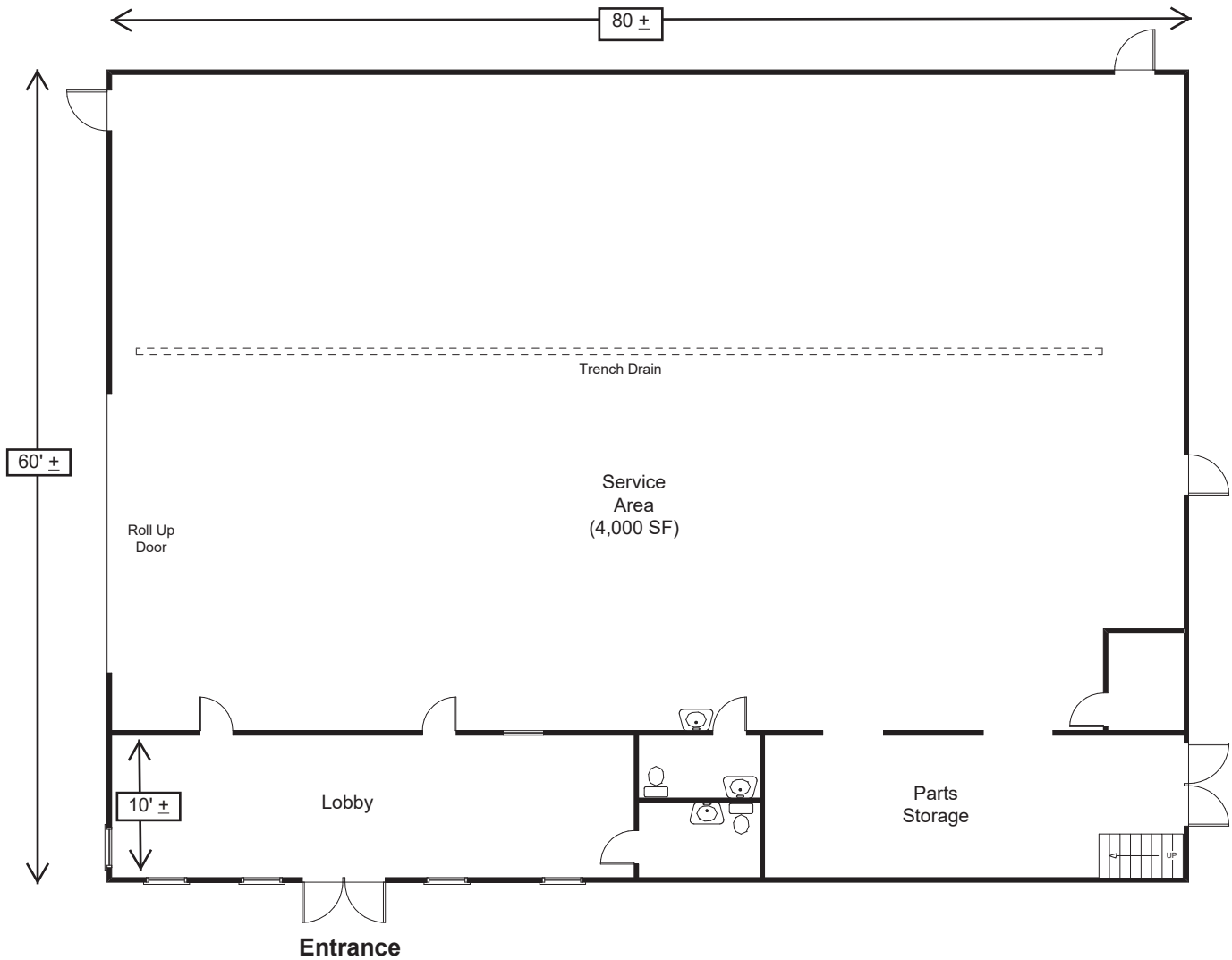

Contact:
JJ Joubran, CCIM
Joubran Commercial Properties
(336) 270-9775
JJ@JoubranCommercial.com
www.JoubranCommercial.com

1212 Battleground Avenue Site Plan

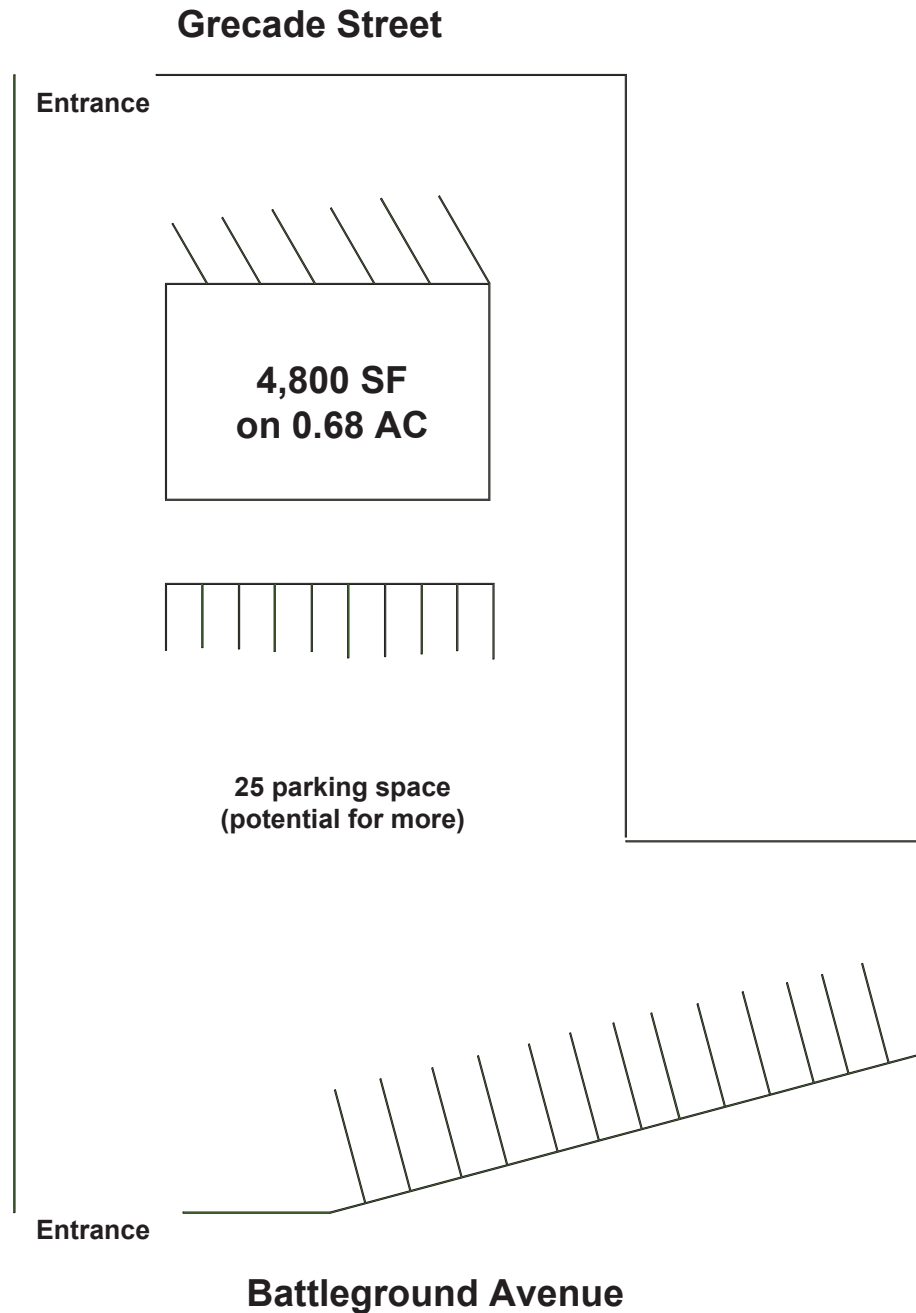

Contact:
JJ Joubran, CCIM
Joubran Commercial Properties
(336) 270-9775
JJ@JoubranCommercial.com
www.JoubranCommercial.com